

# BHM Construction, LLC

License # 900404

221 Gateway Rd West, Suite 405

Napa, Ca. 94558

(707) 643-4580-Tel (707) 643-4581-Fax

Project: Emerald High School Phase 2 Photovoltaic System

## BID CLARIFICATION #2

1. Bid Date: Bids are due December 1, 2023, at 1:00PM.
2. This bid package includes the following:

### Existing Electrical Infrastructure

- a. Site Electrical Plan sheets.
  - i. Sheet ES0.1- North- Showing MDF Location and MSB (Main Switch Board)
  - ii. Sheet ES0.2- Site Plan South

Both ES0.1 and ES0.2 are from the Approved DSA Project Plan set (10.3.2023)

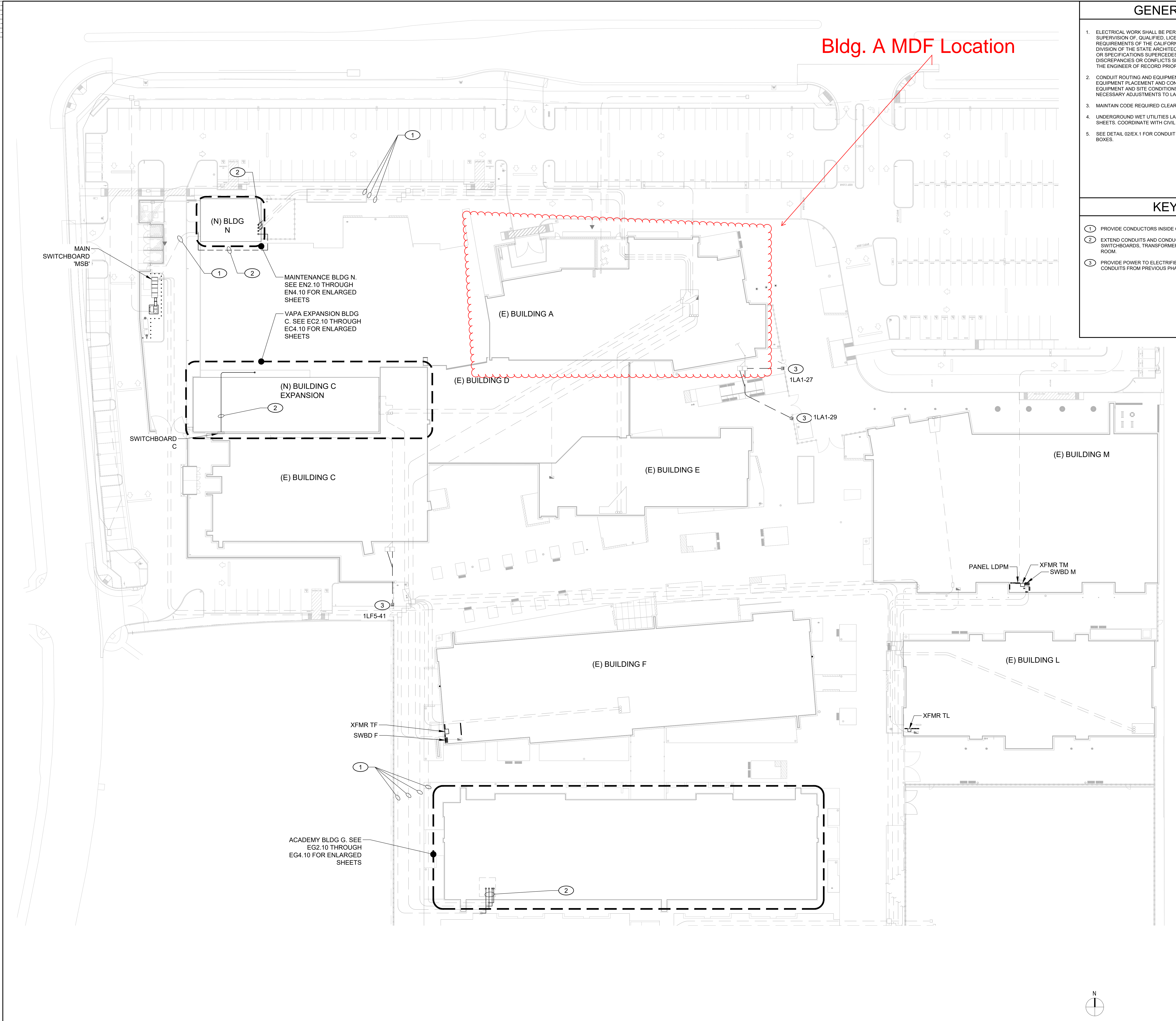

GENERAL NOTES

1. ELECTRICAL WORK SHALL BE PERFORMED BY, OR UNDER THE DIRECT SUPERVISION OF, QUALIFIED, LICENSED PERSONNEL AND PURSUANT TO THE REQUIREMENTS OF THE CALIFORNIA ELECTRICAL CODE (CEC 2019) AND THE DIVISION OF THE STATE ARCHITECT (DSA). NO ASPECT OF THESE DRAWINGS OR SPECIFICATIONS SUPERCEDES THESE REQUIREMENTS. ANY DISCREPANCIES OR CONFLICTS SHALL BE BROUGHT TO THE ATTENTION OF THE ENGINEER OF RECORD PRIOR TO PERFORMING THE WORK IN QUESTION.

2. CONDUIT ROUTING AND EQUIPMENT PLACING IS DIAGRAMMATIC. VERIFY EQUIPMENT PLACEMENT AND CONDUIT ROUTING BASED ON APPROVED EQUIPMENT AND SITE CONDITIONS PRIOR TO COMMENCING WORK. MAKE NECESSARY ADJUSTMENTS TO LAYOUT.

3. MAINTAIN CODE REQUIRED CLEARANCES AROUND EQUIPMENT.

4. UNDERGROUND WET UTILITIES LAYOUT ARE SHOWN ON CIVIL C4-X SERIES SHEETS. COORDINATE WITH CIVIL CONTRACTOR.

5. SEE DETAIL 02/EX-1 FOR CONDUIT STUB UPS AND 17/EX-1 FOR IN GRADE PULL BOXES.

KEYNOTES

1 PROVIDE CONDUCTORS INSIDE OF (E) SITE CONDUITS.

2 EXTEND CONDUITS AND CONDUCTORS FROM (E) UNDERGROUND STUB TO SWITCHBOARDS, TRANSFORMERS, OR PANELS INSIDE OF BUILDING ELECTRICAL ROOM.

3 PROVIDE POWER TO ELECTRIFIED GATE. EXTEND AND CONNECT EXISTING STUB CONDUITS FROM PREVIOUS PHASE TO GATE LOCATION FOR FINAL CONNECTION.

IDENTIFICATION STAMP  
DIV. OF THE STATE ARCHITECT  
APP: 01-120700 INC:  
REVIEWED FOR  
SS ☒ FLS ☒ ACS ☒  
DATE: 10/3/2023

**PRK**  
ARCHITECT  
BERKELEY  
2600 Tenth Street, Suite 700  
Berkeley, CA 94710-2597  
510-450-1595 P

Civil  
T. J. J. J. J.  
Landscape  
K. L. L. L. L.  
Structural  
T. J. J. J. J.  
MEP  
T. J. J. J. J.

MEP Engineering II Technology

**LEAF**  
ENGINEERS  
ARCHITECTS  
665 W. Arroyo Ave., Suite 101  
Oroville, CA 95962  
(530) 833-8889  
leafengineers.com

EMERALD HIGH SCHOOL - CONSTRUCTION OF PHASE II

DUBLIN  
UNIFIED  
SCHOOL DISTRICT

3600 CENTRAL PARKWAY, DUBLIN CA, 94568

KEY PLAN

PLAN TRUE

REGISTERED PROFESSIONAL ENGINEER  
ELECTRICAL  
STATE OF CALIFORNIA  
09/15/2023

CLIENT  
DUBLIN UNIFIED SCHOOL DISTRICT  
DATE  
09/15/2023  
PROJECT NUMBER  
W2109701AR

DRAWING HISTORY

No.	Description	Date

BUILDING NUMBER

ELECTRICAL  
SITE PLAN -  
NORTH

ES0.1



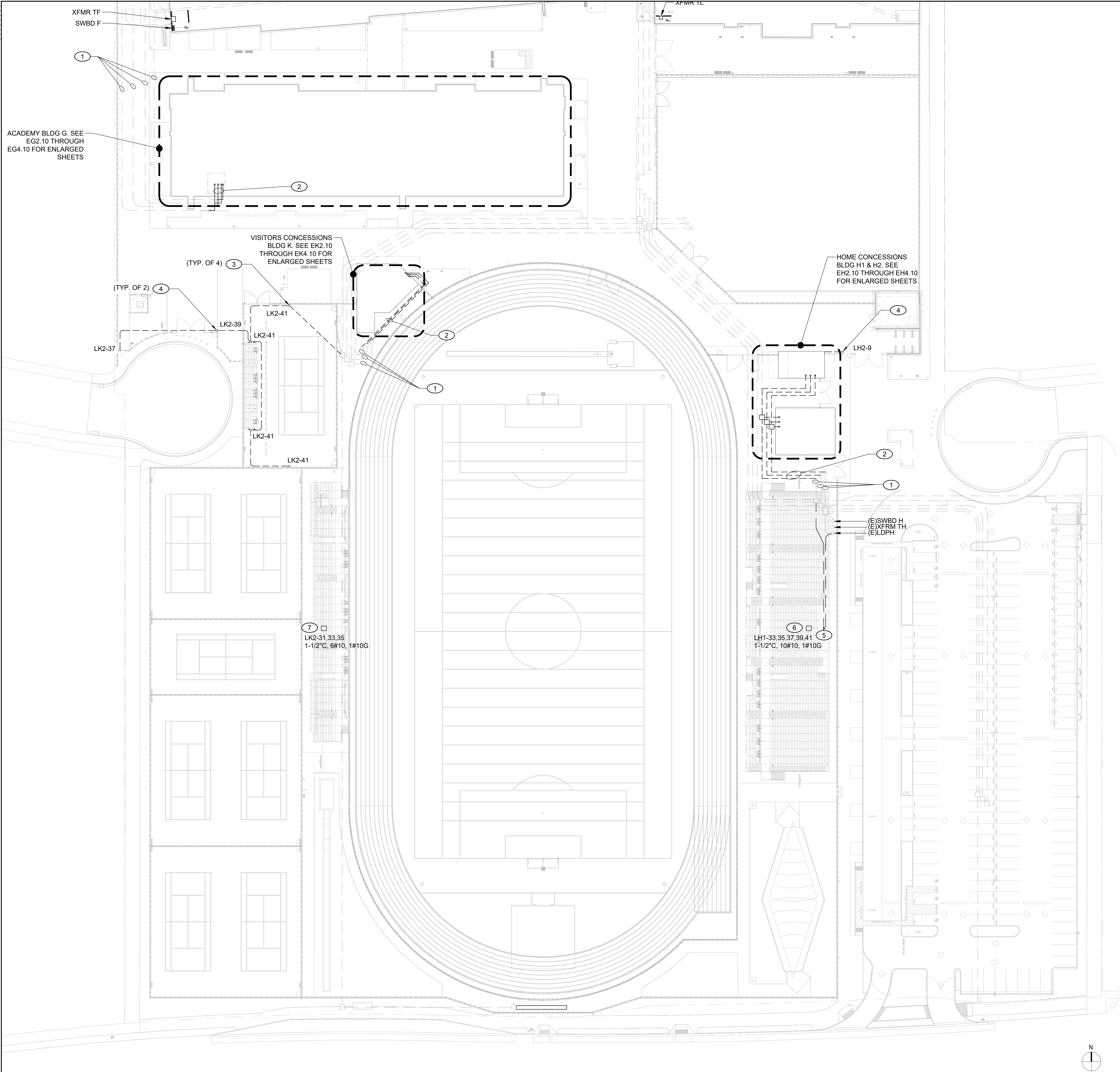

GENERAL NOTES

- ELECTRICAL WORK SHALL BE PERFORMED BY, OR UNDER THE DIRECT SUPERVISION OF, QUALIFIED, LICENSED PERSONNEL AND PURSUANT TO THE REQUIREMENTS OF THE CALIFORNIA ELECTRICAL CODE (CEC 2019) AND THE DIVISION OF THE STATE ARCHITECT (DSA). NO ASPECT OF THESE DRAWINGS OR SPECIFICATIONS SUPERCEDES THESE REQUIREMENTS. ANY DISCREPANCIES OR CONFLICTS SHALL BE BROUGHT TO THE ATTENTION OF THE ENGINEER OF RECORD PRIOR TO PERFORMING THE WORK IN QUESTION.
- CONDUIT ROUTING AND EQUIPMENT PLACING IS DIAGRAMMATIC. VERIFY EQUIPMENT PLACEMENT AND CONDUIT ROUTING BASED ON APPROVED EQUIPMENT AND SITE CONDITIONS PRIOR TO COMMENCING WORK. MAKE NECESSARY ADJUSTMENTS TO LAYOUT.
- MAINTAIN CODE REQUIRED CLEARANCES AROUND EQUIPMENT.
- UNDERGROUND WET UTILITIES LAYOUT ARE SHOWN ON CIVIL C4-X SERIES SHEETS. COORDINATE WITH CIVIL CONTRACTOR.
- SEE DETAIL 02/EX.1 FOR CONDUIT STUB UPS AND 17/EX.1 FOR IN GRADE PULL BOXES.

KEYNOTES

- PROVIDE CONDUCTORS INSIDE OF (E) SITE CONDUITS.
- EXTEND CONDUITS AND CONDUCTORS FROM (E) UNDERGROUND STUB TO SWITCHBOARDS, TRANSFORMERS, OR PANELS INSIDE OF BUILDING ELECTRICAL ROOM.
- PROVIDE NEW GFCI PEDESTALS AT LOCATIONS SHOWN. PROVIDE POWER FROM AVAILABLE CIRCUIT IN PANEL LK2. EXTEND AND CONNECT EXISTING STUB CONDUITS FROM PREVIOUS PHASE TO NEW UNDERGROUND RACEWAYS TO PEDESTALS. SEE DETAIL #15/EX.1.
- PROVIDE POWER TO ELECTRIFIED GATE. EXTEND AND CONNECT EXISTING STUB CONDUITS FROM PREVIOUS PHASE TO NEW UNDERGROUND RACEWAYS.
- PRESS BOX PANEL LP. EXTEND CONDUIT FROM EXISTING STUB UP AND PULL WIRE TO POWER PRESS BOX PANEL. SEE E6.1 SINGLE LINE DIAGRAM FOR FEEDER TO SERVE PANEL LP.
- 5G-LTE ENCLOSURE ON GROUND LEVEL. PROVIDE (2) 30A, 120V AND (3) 20A 120V DEDICATED CIRCUITS TERMINATED INSIDE THE ENCLOSURE. TERMINATE 30A CIRCUITS TO THE MIDDLE ATLANTIC RLM30-530-1 UNITS. PROVIDE A SEPARATE CIRCUIT FOR THE ENCLOSURE A/C UNIT. PROVIDE (2) 2" CONDUITS ROUTED UP TO THE PRESS BOX TERMINATED TO AN 6X8X4 NEMA ENCLOSURE IN KNEE SPACE AT SOUND RACK LOCATION. PROVIDE (1) 2" CONDUIT ROUTED UP TO THE PRESS BOX AND STUBBED OUT ABOVE CEILING FOR DATA CABLING.
- 5G-LTE ENCLOSURE ON GROUND LEVEL. PROVIDE (2) 30A, 120V AND (1) 20A 120V DEDICATED CIRCUITS TERMINATED INSIDE THE ENCLOSURE. TERMINATE 30A CIRCUITS TO THE MIDDLE ATLANTIC RLM30-530-1 UNITS. PROVIDE A SEPARATE CIRCUIT FOR THE ENCLOSURE A/C UNIT.

IDENTIFICATION STAMP  
DIV. OF THE STATE ARCHITECT  
APP: 01-120700 INC:  
REVIEWED FOR  
SS ☒ FLS ☒ ACS ☒  
DATE: 10/3/2023

**PRK**  
ARCHITECT  
BERKELEY  
2600 Tenth Street, Suite 700  
Berkeley, CA 94710-2597  
510-450-1595 P  
PRK.com

Civil  
T 110-211000  
Landscape  
T 110-211000  
Keller W. Hines & Co.  
T 110-211000  
Structural  
T 110-211000  
MEP  
T 110-211000  
LEAF ENGINEERS  
T 110-211000

MEP Engineering & Technology  
**LEAF ENGINEERS**  
P E R M I T T E D  
CLD/VE  
885 W. Arden Ave., Suite 101  
Oakland, CA 94612  
510-231-8889  
leafengineers.com

EMERALD HIGH SCHOOL - CONSTRUCTION OF PHASE II

DUBLIN  
UNIFIED  
SCHOOL DISTRICT

3800 CENTRAL PARKWAY, DUBLIN CA, 94568

PLAN TRUE

KEY PLAN

REGISTERED PROFESSIONAL ENGINEER  
ELECTRICAL  
STATE OF CALIFORNIA  
09/15/2023

DUBLIN UNIFIED SCHOOL DISTRICT  
DATE: 09/15/2023  
PROJECT NUMBER: W2109701AR

DRAWING HISTORY  

No.	Description	Date

BUILDING NUMBER

ELECTRICAL  
SITE PLAN -  
SOUTH

ES0.2



## Mike Flewell

---

**From:** Phil Stenson  
**Sent:** Friday, November 17, 2023 12:41 PM  
**To:** Mike Flewell  
**Subject:** Fwd: EMERALD HIGH SCHOOL PHASE 2 - PHOTOVOLTAIC SYSTEM

Sent from my iPhone

Begin forwarded message:

**From:** BIDDAY <bids@bhmconstruction.com>  
**Date:** November 17, 2023 at 12:40:04 PM PST  
**To:** Phil Stenson <phils@bhmconstruction.com>  
**Subject:** FW: EMERALD HIGH SCHOOL PHASE 2 - PHOTOVOLTAIC SYSTEM

---

**From:** Benjamin Deletetsky <bdeletetsky@solartechnologies.com>  
**Sent:** Friday, November 17, 2023 10:37 AM  
**To:** BIDDAY <bids@bhmconstruction.com>  
**Subject:** EMERALD HIGH SCHOOL PHASE 2 - PHOTOVOLTAIC SYSTEM

We are interested in bidding the Emerald High School Phase 2 - Photovoltaic System project. Can you please provide electrical and tele-data infrastructure drawings for the campus? We will need this information to determine where the PV systems will be interconnected.

Thanks,

**Ben Deletetsky | 408.406.9636**  
**Preconstruction Director**  
**Solar Technologies**  
23 Las Colinas Ln., Suite 106, San Jose, CA 95119

[bdeletetsky@solartechnologies.com](mailto:bdeletetsky@solartechnologies.com)

[www.solartechnologies.com](http://www.solartechnologies.com)